

Fusion3

EDGE 3D Printer

REPAIR:

BED BUSHING REPLACEMENT

Revision 2/23/2023

HOW TO REPLACE THE BED BUSHINGS ON EDGE

If one of the bushings becomes damaged or broken, you can replace it by following these instructions.

REMOVE DAMAGED BUSHING

1. If the bushing you need to replace is in the back, you will want to remove the rear service panel for easier access.
2. Loosen or remove all 4 screws holding the bed to the bushings. You need the bed to be loose enough that you can lift it up ~1 inch at the corner where you're replacing the bushing.

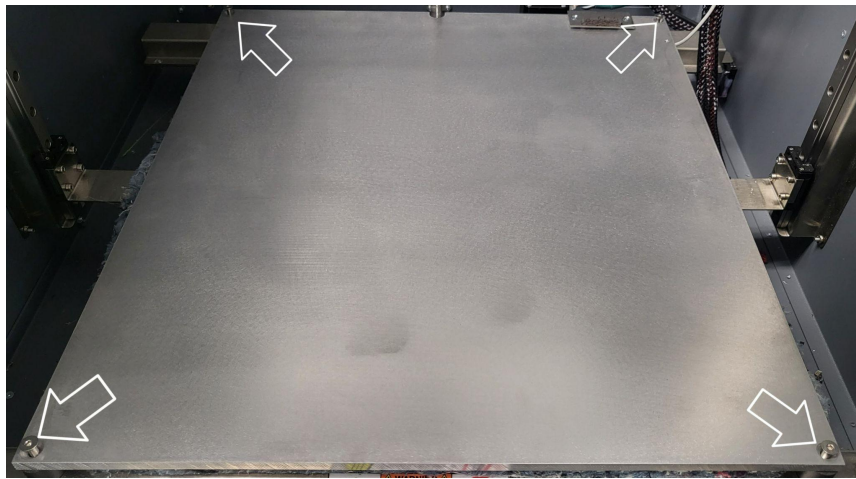

3. If you remove all the screws, take care that the bed doesn't shift too much and put strain on the wires.
4. Using your fingers, unthread the damaged bushing from the bed substrate (sheet metal structure). Grasp the bushing close to the base so that you're not applying torque to the rubber body.

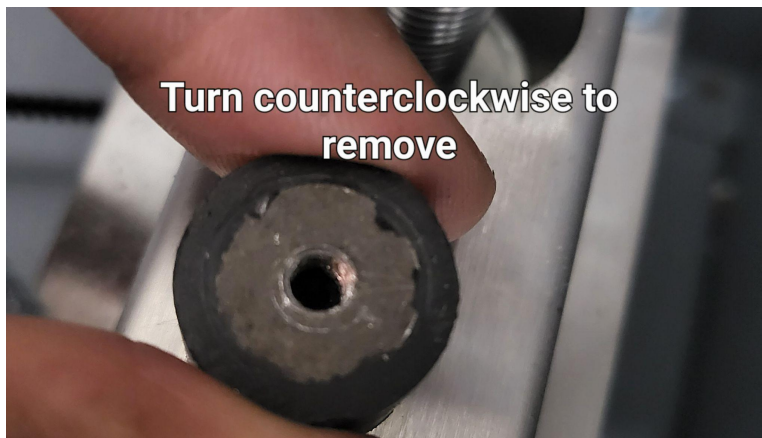

INSTALL NEW BUSHING

Note: We sent replacement bushings in a kit of 4, but it's not necessary to replace all the bushings at once unless they're all damaged.

1. Using your fingers, thread the new bushing into the threaded hole. Grasp the bushing near the base so you're not applying torque to the rubber body. **DO NOT** use tools such as pliers to install the bushing; you may damage it and cause it to fail.

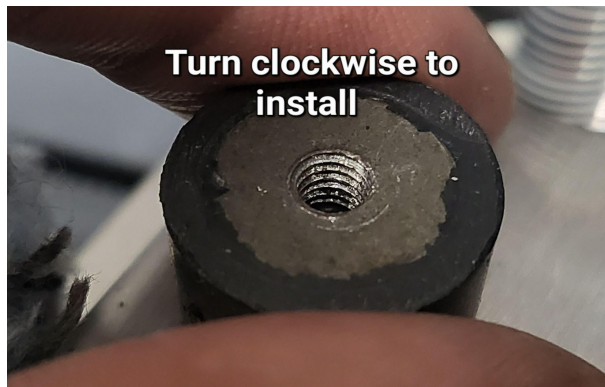

2. The bushing is fully installed when it stops turning. The bottom face of the bushing may have a small gap between it and the bed substrate. **THIS IS OK.**



3. Place the bed back on top of the bushings. Reinstall the screws. **Do not** apply more than 10 in-lb of torque; over-torquing these screws may damage the bushings. A small dab of **blue loctite** is ok but not required.
4. Since there may be slight height variations between your old and new bushing, we recommend running *Utilities > Bed Leveling > Run Auto Level* and make adjustments to the bed level as needed.

TROUBLESHOOTING

I can't remove the old bushing - it's stuck.

You may need to use slip-jaw pliers and grip at the very base of the bushing, where the bottom metal plate is. Grip the bushing firmly and attempt to unthread it. After it's out, you should run a screw through the hole to check for damaged threads or loctite in the threads.